



IF.M14S.48.000.4S

Rozeta „S” Ø48 mm

Point fitting's rosette Ø48 mm, „S” type

 AISI 304

 inox stainless steel

 10 - 21,52 mm

 Ø23 mm



Opis

Description

Rozeta mocowania punktowego o średnicy Ø48 mm do mocowania na szpilce M14. Rozeta typu „S” - o płaskiej powierzchni, rozeta mocowana na śrubę ampulową, krawędzie rozety fazowane.

Point fitting rosette with diameter of Ø48 mm for assembling on a M14 pin. „S” type rosette - head of point fitting have a flat surface and is assembled on a flat head hex socket screw, rosette edges bevelled.

Wymiary Dimensions

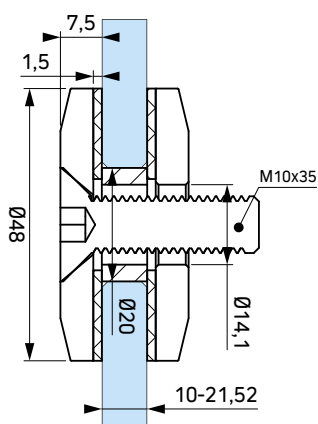

Otworowanie szkła
Glass processing

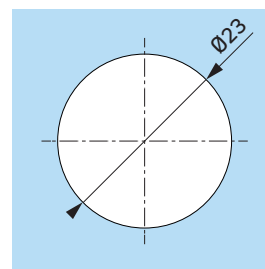

Produkty uzupełniające Complementary products

ID	
IF.M14.M10.080.4S	80 mm
IF.M14.M10.090.4S	90 mm
IF.M14.M10.100.4S	100 mm
IF.M14.M10.110.4S	110 mm
IF.M14.M10.120.4S	120 mm

IF.M14.M10.---.4S

